

City of... Black Diamond

Black Diamond is a rural community treasured for its deep history beautiful scenery and friendly Residents. The City of Black Diamond is located between Maple Valley and Enumclaw.

Parks, Recreation and Community Facilities -

The Black Diamond Utility Department implemented significant improvements to the tennis courts park in 2003. You can also visit the museum, Bookstore, and Bakery while in town. Some parks you can visit are Flaming Geyser State Park, Knotty State Park, and Konasket Palmer. You can also visit the Green River Gorge and Lake Sawyer. The Union Stump Park has been transformed from a tangle of blackberries and weeds into a delightful resting place complete with excellent historical information that furthers the goal of preserving Black Diamond's important history as it grows and expands.

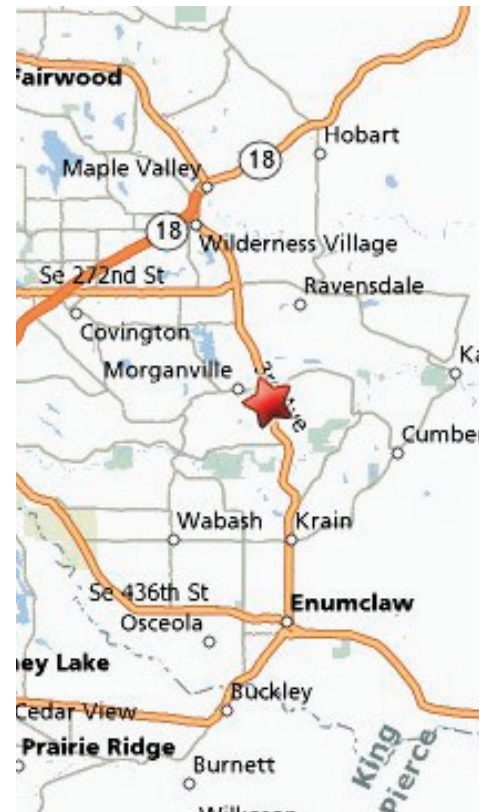

Puget Sound Energy (Electricity & Natural Gas)

888-225-5773

Water & Sewer

- Soos Creek Water District
- City of Black Diamond

253-630-9900

360-886-2560

Garbage Service

- Meridian Valley
- City of Black Diamond

206-682-9730

360-886-2560

Telephone Service - Qwest

800-244-1111

Comcast Cable

800-266-2278

Licensing - Covington

253-630-7090

Post Office - Black Diamond

360-886-9429

Black Diamond Library

360-829-0300

Voter Registration

800-448-4881

Newspaper - Enumclaw Courier-Herald

360-825-2555

Hospital - Enumclaw Regional Hospital

360-825-2505

Black Diamond City Hall

360-886-2560